

2 Option Master Closet
3/16" = 1'-0"

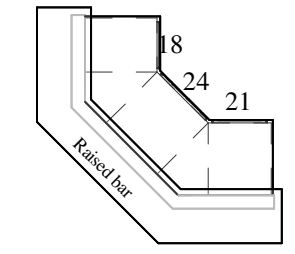

3 Option Raised Island
3/16" = 1'-0"

1 Floor Plan Presentation
3/16" = 1'-0"

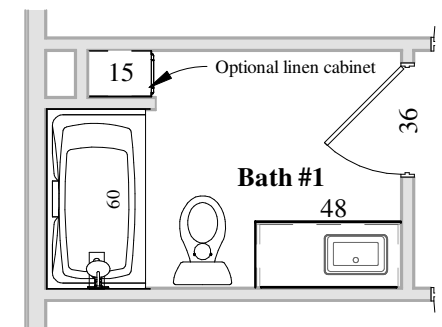

4 Option Bath #1 Linen
3/16" = 1'-0"

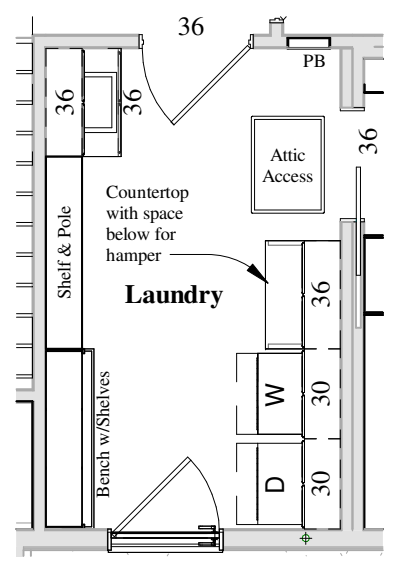

5 Option Laundry Countertop
3/16" = 1'-0"

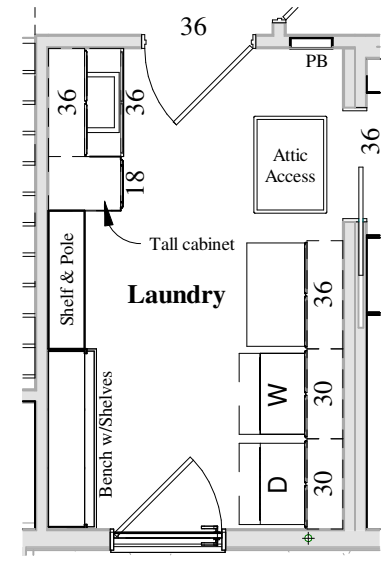

6 Option Laundry Linen
3/16" = 1'-0"

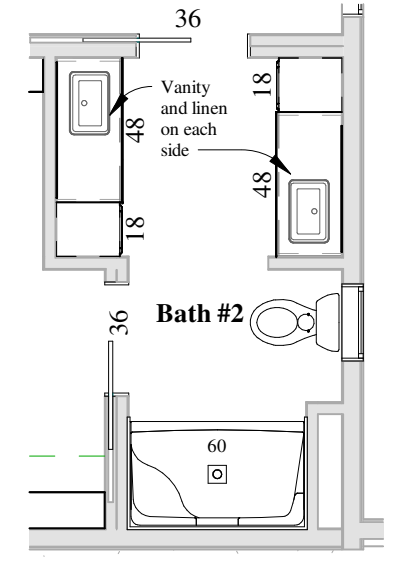

7 Option Bath #2 Vanities
3/16" = 1'-0"

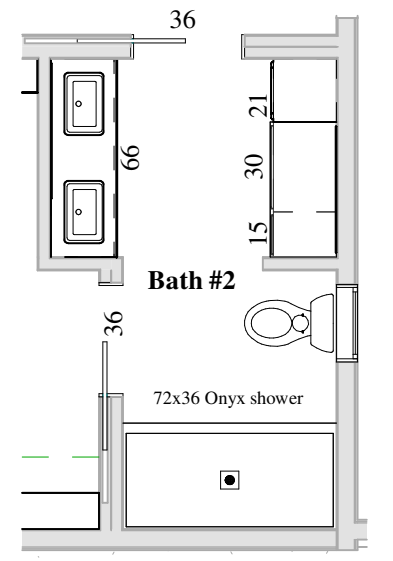

8 Option Bath #2 Onyx Shower
3/16" = 1'-0"

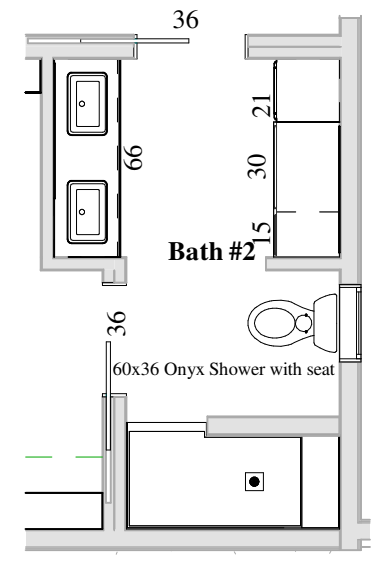

9 Option Bath #2 Onyx Shower Seat
3/16" = 1'-0"

BY	REVISION DATE / DESCRIPTION
PB	12/06/24 Draft
WCH/Builder	
Supplier	
Date: _____	
Date: _____	
Date: _____	
The Imperial II Residence	
Address: TBD	
THE SUPPLIER AND HOMEOWNER HAVE REVIEWED AND APPROVED: _____	
PRELIMINARY. THE FLOORPLAN & SUBMITTED REVISIONS AS NOTED. Supplier: _____	
FLOORPLAN WILL BE FINALED UPON RECEIPT OF PRELIMINARY. Homeowner: _____	
FINAL: THE FINAL FLOORPLAN FOR PRODUCTION. Homeowner: _____	

WARD CRAFT HOMES
1-888-927-3272 (TOLL FREE)

Plot: 12/12/2024 7:38:07 AM
Scale: AS NOTED
Ref: 6092
PROJECT: NC122
SHEET: Z200
COPYRIGHT 2024