

FRONT ELEVATION

Scale: N.T.S.

#	BY	REVISION DATE / DESCRIPTION
1	TM	04-28-17 2ND PRELIM
2	TM	05-19-17 FINAL FOR PRODUCTION

The HITZEMAN Residence Vitosh Construcion & Sales Inc
 62189 732 Rd Tecumseh, NE 68450
 SUPPLIER

Supplier: _____ Date: _____
 Homeowner: _____ Date: _____
 Homeowner: _____ Date: _____

THE SUPPLIER AND HOMEOWNER HAVE REVIEWED AND APPROVED:
 PRELIMINARY: THE FLOORPLAN & SUBMITTED REVISIONS AS NOTED.
 FLOORPLAN WILL BE FINALED UPON RECEIPT OF PRELIMINARY.
 FINAL: THE FINAL FLOORPLAN FOR PRODUCTION.

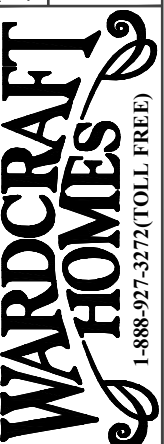

DATE:	04-24-17
SCALE:	AS NOTED
DRAWN:	TM
PROJECT:	5633
SHEET	A-1
COPYRIGHT 2017	

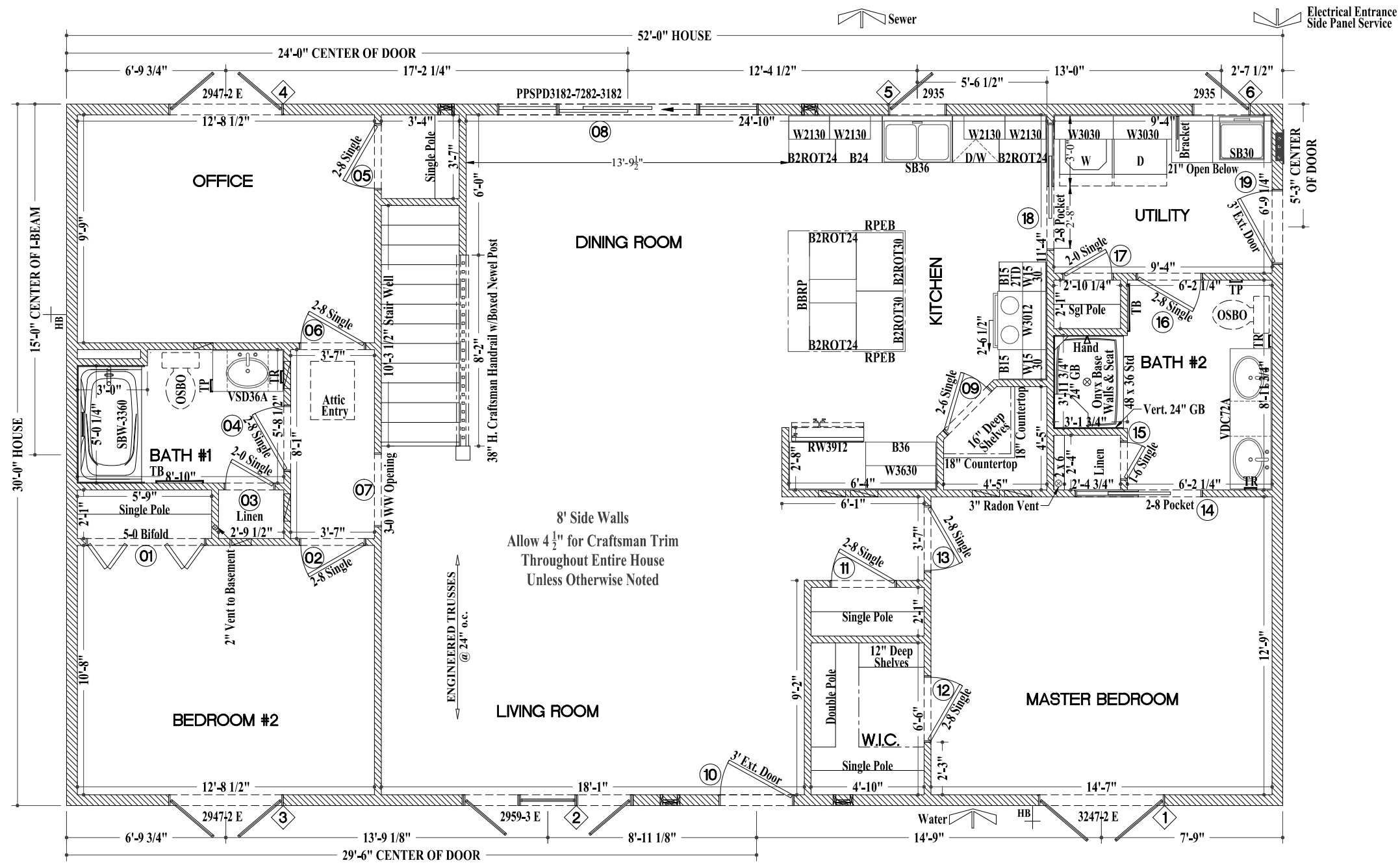

#	BY	REVISION DATE / DESCRIPTION
1	TM	04-28-17 2ND PRELIM
2	TM	05-19-17 FINAL FOR PRODUCTION



SCALE: AS NOTED
 DRAWN: TM
 PROJECT: 5633
 SHEET: A-2a
 COPYRIGHT 2017